



# QuickTest BT A+B



## Feline procedure for blood typing test

1



2

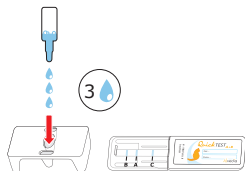

3



Blood tube in  
ACD/CPD/EDTA  
Do not use Heparin

Use 10µL of whole  
blood or packed  
red blood cells  
(if anemic)

4



7 sec

5

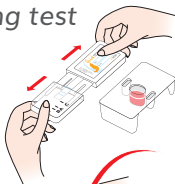

6



7



Wait until  
complete  
migration  
2 to 5 min

8



C = CONTROL LINE

Read immediately after testing

A

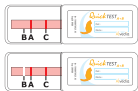

B

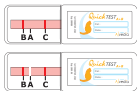

AB



Contact us





# QuickTest BT A+B

Result form for Feline Blood Typing

Patient name : .....

Identification code : .....

Owner : .....

Blood type :  **A**       **B**       **AB**

Blood Typing performed by :

Veterinarian

Date : .....

QT lot number : .....

## BLOOD TYPE COMPATIBILITY

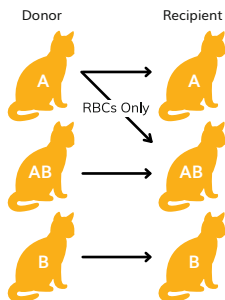

Compatible transfusions are indicated by arrows.

### Before any transfusion

- Always verify AB blood compatibility between donor and recipient.
- For all other blood types : perform a crossmatch test (XM) between donor and recipient.

I agree to be a blood donor

Alvedia  
Alice Veterinary Diagnostic